

HANDBOOK

for Parents & Campers

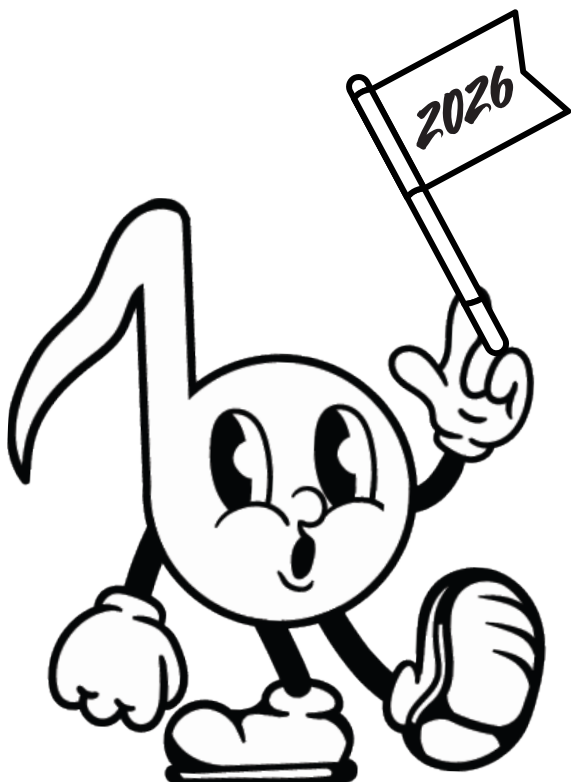

Week 1 (June 07-13, 2026)

Choral Ensemble Camp, Treble Choir Camp,
Jazz Ensemble Camp

Week 2 (June 14-20, 2026)

Piano Institute, High School Band Camp Session 1,
String Orchestra Camp Session 1

Week 3 (June 21-27, 2026)

High School Band Camp Session 2,
String Orchestra Camp Session 2

Week 4 (June 28-July 04, 2026)

Middle School Band Camp

**Elementary Music Day Camp and Marching Band Leadership Camp
have separate handbooks.*

Welcome Families

A fantastic week of music & memories is coming your way!

We are so glad that your family will be joining us for music camp this summer. We know that the process of getting ready for camp can seem overwhelming, but this handbook should answer many of your questions. We encourage parents to be active participants in camp preparation, and we appreciate that you are taking the time to read this handbook closely. There will be some information in this handbook which only applies to night campers, and some information which only applies to day campers, but our camp classes and activities are for ALL of our campers.

We look forward to seeing you at camp!

TABLE OF CONTENTS

CAMP ESSENTIALS	03
MAP & TRAVEL	04-05
CHECK IN, AUDITIONS, OPPORTUNITIES	06-11
INSTRUMENTS	12-13
HEALTH & WELLNESS	14-15
DAY CAMPER DETAILS	16-18
NIGHT CAMPER DETAILS	19-21
F.A.Q	22-23
PERFORMANCES	24-25
CAMP A-Z	26-29
CAMP SCHEDULES	30-34

Camp Essentials

Meet Our Staff

CAMP DIRECTOR: Dr. Steven Kelly, *Professor of Music Education, Florida State University*

ASSOCIATE CAMP DIRECTOR: Dr. Mark Belfast, *Assistant Professor of Music Education, Florida State University*

PROGRAM COORDINATOR: Mrs. Kerry Smith

ASSISTANT CAMP DIRECTORS: Mr. Lee Commander, Ms. Sarah Leaman, Mr. Zachary Pecore

SUPERVISING COUNSELORS: Mr. Taylor Haworth, Mr. Greg Lambert, Mr. Nick Lohse, Ms. Meagan O'Rourke



CONTACTING US

ADMINISTRATION OFFICE: 850-644-9934
Open Monday - Friday, 8am-5pm

Admin Office Address:
FSU College of Music Summer Music Camps
PO Box 3061180
Housewright Music Building Room 236
Tallahassee, FL 32306-1180

ADMINISTRATION EMAIL: musiccamps@fsu.edu

SOUTHGATE DORM OFFICE:

A phone number for this office will be available once camp starts.

Dorm Address:
The Southgate Campus Center
675 West Jefferson Street, Tallahassee, FL 32304
Camp Office is on the 2nd Floor



CAMPER EXPECTATIONS

Nothing is more important to us than the well-being of our campers. We are vigilant about emotional safety, physical safety, creating a place where campers feel safe and supported in reaching their goals, and where everyone can have fun. To this end, the FSU Summer Music Camps requires all campers and parents to read, agree to, and abide by the [Camper Conduct Contract](#). The electronic version of this form which you will sign is in your online account.



YOUR ONLINE ACCOUNT AND CAMP FORMS

When you registered, you created an online account where you make payments, fill out camp forms, select add-on services, and more. To access your account go to:

<https://campself.active.com/floridastateuniversitycollegeofmusic>

The forms in your online account include required camper forms and some optional forms as well. Please fill these forms out as soon as possible, as they help us plan for your arrival and provide you with a great camp experience. Once submitted, forms can be updated or edited by calling or emailing our office.



CANCELLATION POLICY AND CONSENT WAIVER

During registration you were asked to sign two waivers:

the [Statement of Voluntary Consent](#) and the [Financial](#)

[Responsibility Agreement](#). PDF versions of these waivers can be accessed using the provided links. You may need to electronically sign these forms as part of your online forms if you did not complete them during registration.



THE CAMP APP

We use our camp app to send out text message reminders with information and changes, and to share photographs of the campers. You can download the app in the Apple App Store or Google Play Store under "FSU Music Camps". To log in, your username is the same as your online account that you used for registration.

Camp Map

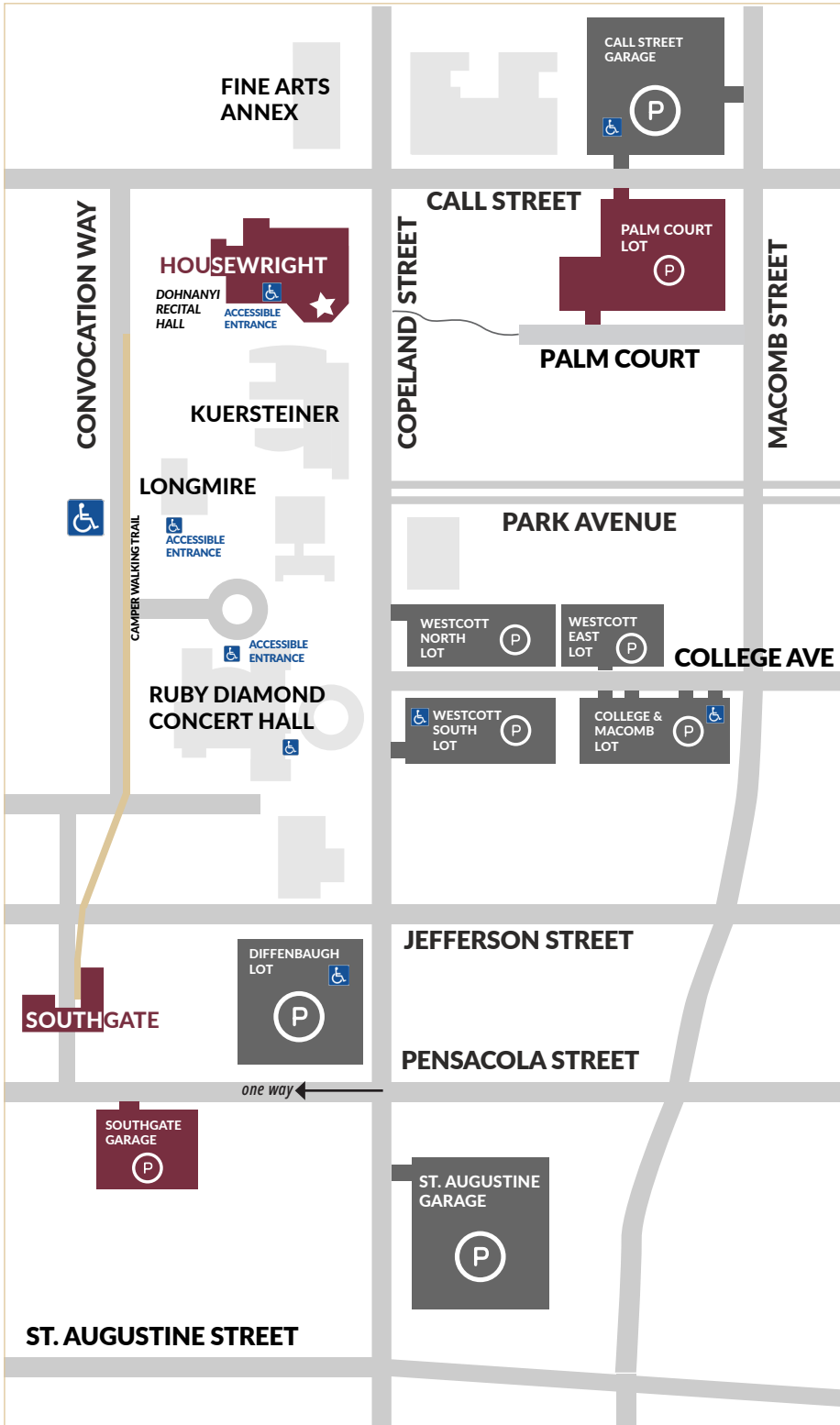

LOCATIONS

Camp activities take place on the campus of Florida State University in Tallahassee, FL. Classes will be held in the Housewright Music Building, Kuersteiner Music Building, Longmire Building, Westcott Building, UKirk Building and the Fine Arts Annex.

Evening activities will take place on campus and off-campus; off-campus recreation activities are optional and transportation is via an accredited bus service.

ADDRESSES:

Our main campus location in the Housewright Music Building, including check-in:

122 North Copeland Street
Tallahassee, FL 32306

Parking lot for check-in:

555 Palm Court
Tallahassee, FL 32306

Southgate Dorm:

675 West Jefferson Street
Tallahassee, FL 32304

Southgate Parking Garage:

675 West Pensacola St
Tallahassee, FL 32304

Locations shown in **GARNET** on this map are check-in locations. Check-in details begin on page 6.

Campers will be supervised on a walking "trail" (shown in **GOLD**) when they travel back and forth between the music buildings and the dorm.

Travel

Driving Directions and Parking



The address to use for the check-in location is: **122 North Copeland Street, Tallahassee, FL 32306.**
The address for the recommended parking lot for check-in is **555 Palm Court, Tallahassee, FL 32306.**

You do not need a parking permit for check-in day. University Lots are available for parking all day Sunday without a permit.



Traveling West on I-10 (from Jacksonville/I-75/I-95):

- Take exit 209A for US 90 W
- Continue west on US 90 W (aka Mahan/Tennessee Street)
- Turn left (south) onto Copeland Street
- The Housewright Music Building is located on right after Call St (traffic light) intersection

Traveling East on I-10 (from Panama City):

- Take exit 199 to US 27 S (Monroe St)
- Drive south on US 27/Monroe Street
- Make a right (going west) onto Tennessee Street
- Turn left (south) onto Copeland Street
- The Housewright Music Building is located on right after Call St (traffic light) intersection



Overnight campers who drive themselves to camp do NOT need to purchase a parking permit. Overnight students can park in the Southgate Parking Garage for the duration of camp. Students are not allowed to drive once they have checked-in, and will need to turn in their keys to the dorm staff upon arrival.



Day campers who will drive themselves to camp each day will need a parking permit beginning Monday morning. Information about purchasing a permit can be found on page 11. Day campers who are dropped-off and picked-up daily do not need a parking permit.



Shuttle Service

If you choose to send your camper to Tallahassee via plane or bus, you have the option to arrange for our staff to pick up your child. This service is intended for campers traveling by themselves.

Locations that we offer service to and from:

- Tallahassee International Airport (TLH)
- Greyhound at 112 W Tennessee St
- Red Coach Bus Doak Campbell Stadium Stop

Detailed information about Shuttle Service can be found under the **Travel** section of our website. You can purchase this add-on service in your online camp account. Once you purchase shuttle service, we will be in contact with you to collect your travel details.



Hotel Discount and Area Hotels

The **DoubleTree Hotel** has been our host hotel for the past fifteen years! The DoubleTree Hotel is conveniently located in downtown Tallahassee, and is just up the street from our College of Music Buildings.

2026 Rate: \$119 & tax per room per night.

Prevailing parking fee will apply.
[Online Reservations Click Here](#)

Information on other area hotels can be found at **visittallahassee.com** and on the **Travel** section of our website.

Check In Day

Camp check-in is important to getting your camp started off right! But it does not have to be stressful. If you plan ahead, it will be a fun and exciting day!



When To Arrive

ALL CAMPERS MUST ATTEND CHECK-IN, INCLUDING DAY CAMPERS. If you can't attend check in due to extenuating circumstances, please contact our office to make arrangements and get additional instructions.

You will be assigned an arrival time. Time slots help us minimize lines, and make the process faster for you! If you need to change your arrival time, call us or send an email and we will find you a time that works. This is **NOT** your audition time - just the time you should arrive to check-in.

- Be sure you factor in meal times during check-in day (it's not fun if you're hangry).
- Wear comfortable, cool clothing and good walking shoes.
- Look for staff in black polo shirts if you have questions. We're here to help!



Where To Go

Check-in begins at the Housewright Music Building at 122 N. Copeland Street, Tallahassee, FL 323206. The suggested parking lot and all addresses are marked on the [Camp Map](#) on page 4.

When you arrive, all you need to bring inside is yourself, your instrument, your music stand, music for your placement audition, and money to pay for optional items. Leave your luggage in your car.



What To Expect

Camp t-shirts will be on sale in the main lobby.

You will start at our Welcome Station to pick-up your name tag.

If any required forms or payments are outstanding, we will have you complete them at this time.

You will visit specialty stations that vary by camp, including optional private lesson sign-up.



Auditions

If your camp has a placement audition, or optional auditions, you will be directed to warm-up in practice rooms. More information about auditions can be found on pages 8-9.



Where To Head Next

Day Campers:

Day campers can leave once they have finished all stations, and have completed any applicable auditions. Plan to return on Monday morning between 7:30-7:45am to pick up your schedule and go to your first class. Specific day camper information starts on page 11.

Night Campers:

Night campers can leave the music building once they have finished all stations, have completed any applicable auditions, and stored their instrument as indicated on the back of their name tag. Follow the directions on the next page to go to the dorm for check-in. →



Dorm Check-In

Drive to the Southgate Campus Centre Parking Garage (located at **675 West Pensacola St., Tallahassee, FL 32306**) for dorm check-in. When you arrive to the dorm **LEAVE YOUR BAGS IN YOUR CAR!** All you should bring inside is yourself, and medications if the dorm staff will be supervising them (see **Medications** on page 15 for more information about your medication options.)

Our counselors will be stationed on the ground floor. Once you have received a room key, you are officially under the supervision of the camps.

INFO FOR DORM CHECK-IN

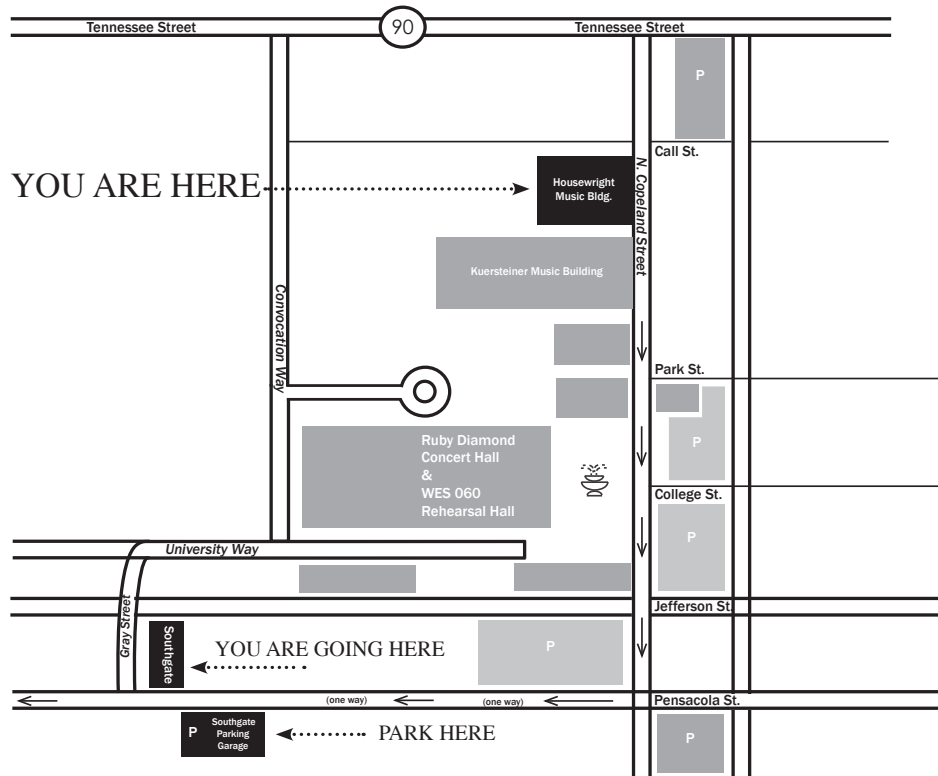

DO NOT BRING YOUR LUGGAGE INTO THE DORM UNTIL AFTER YOU HAVE RECEIVED YOUR ROOM KEY.

AFTER you receive your room key, you can return to your car, get your bags, and head to your room. Use this time to get settled, and meet your new friends and counselors. Parents are free to leave at any time. More information about the dorm begins on page 19.

Check In Day Continued:

Placement Auditions

The goal of the placement audition is to set the camper up for a great week of instruction.

The placement audition will be used to determine the campers schedule for large ensemble, small ensemble, and/or chair assignments. Our instructors want all campers to get the most out of their time at camp, and we stand behind the decisions that they make. We encourage campers to prepare for the placement audition and then to trust in the decisions of the FSU educators to place them in appropriate classes & ensembles.

We are proud that our campers have the opportunity to play alongside a diverse group of student musicians from over 40 states and international cities. Our campers come from a wide variety of musical experiences and backgrounds, and therefore, the ensemble placement or the seating assignment that your camper receives may not be what they are used to back home.

Changes will NOT be made to assignments.

If you miss the placement audition at check-in, you will need to do your audition on Monday morning before you can go to any classes. Because the other students will have been placed already, the late audition will likely effect your chair assignment. For High School Band students, missing the Sunday placement audition will make you ineligible for the Wind Symphony and for Orchestra Winds.

What music should I pick for my audition?

Read through the requirements for your camp on the next page. When selecting music we suggest selecting

- Pieces that showcase your talent and highlight your best skills.
- Pieces that you can play through with confidence even when you are nervous.

We encourage you to come to the audition with the BEST prepared material that you have. Length is rarely a factor, though the more you are able to showcase the better idea the audition proctors have for placements. We suggest you bring in your best technical and lyrical work that showcases your abilities as a musician.

Piano Institute

There is no placement audition, but you do need to prepare your music in advance. Students should prepare two classical pieces that are performance ready. These pieces should be memorized and should not exceed 6 minutes. Please bring the original sheet music with you. Works should be of standard classical repertoire (no rock, pop, musicals, or film scores). This will be the music you will focus on in private lessons and masterclasses, and will possibly be the music you perform at the final recital.

Choral Ensemble Camp & Treble Choir Camp

There are no placement auditions for either of these camps, but there are optional auditions for Choral Ensemble Camp. More information about the optional Chamber Choir and/or Honors Solo Recital auditions are on page 10.

Check In Day Continued:

Placement Auditions

Audition room locations will be printed on your name tag and posted around the buildings.

The check-in arrival time that you are assigned is **NOT** your audition time.

Depending on your camp, your instrument, and how many other people arrive at the same time as you, you might find that you can do your audition immediately or you may have to wait in line. Warm-up rooms will be available.

String Orchestra Camp (Sessions 1 & 2)

- 2 scales of your choice
- 1 solo piece of your choice (technical, lyrical or both).
- You may be asked to sight read.

Jazz Ensemble Camp

ALL campers should perform Billie's Bounce*.

- Quarter note = 120 bpm
- Play 2x through the head (24 bars)
- Play 2 choruses of improvisation (24 bars)

**Billie's Bounce is a jazz standard and can be found in hundreds of collections and online. If you are having trouble finding this piece of music please contact our office.*

Sight Reading

All campers will be asked to sight read a short selection.

Scales:

Winds

- Quarter note = 120 bpm
- Major Scales (two octaves when possible): F, B-flat, E-flat, and G

Piano, Guitar, and Bass

- Major Scales (two octaves): F, B-flat, E-flat, A-flat, and G
- Minor scales (two octaves): d, g, c, f, e-flat

Rudiments and Styles (Drums Only)

Rudiments

- 5-Stroke Roll
- 10-Stroke Roll
- Single Paradiddles

Styles

- Slow Swing (quarter note = 60 bpm)
- Up-tempo Swing (quarter note = 240 bpm)
- Samba (any tempo)
- Rock (any tempo)
- Funk (any tempo)

Middle School Band Camp & High School Band Camp (Sessions 1 & 2)

For all instruments except percussion:

- 2 scales of your choice
- 2 solo excerpts, etudes, or short pieces. You can select two movements of the same piece.
 - 1 piece should be slower & lyrical,
 - 1 piece should be faster and more technical.

For Percussion: Prepare one snare piece and one mallet piece. Students may be asked to model two scales of their choice and perform a short sight reading.

Check In Day Continued:

Optional Opportunities

Some of our camps offer optional honors opportunities, and require a separate audition.

These optional auditions take place at check-in. If you do not arrive during the regular check-in window, then you will not be eligible. Campers will find out if they were selected on Sunday evening when they receive their daily class schedule.

▶ OPPORTUNITY: Honors Solo Recital with Solo Recital Practice Elective
APPLIES TO: High School Band Camp (Sessions 1 & 2) and String Orchestra Camp (Sessions 1 & 2)

The Honors Solo Recital is a special performance on the Thursday night of camp that will feature solo performances from selected campers from both band and orchestra. Selected students will be automatically assigned to "Solo Recital Practice" as one of their two daily elective classes. They will be able to use this time to prepare and receive some coaching on the piece for the recital.

Family of the performers are welcome to attend the performance (Session 1: June 18, Session 2: June 25). The performers will receive an audio recording of the recital.

What to prepare if you wish to audition:

- Prepare a solo piece of your choice. Select movement(s) from a work is acceptable.
- Only solos are acceptable. No ensembles, no trios, no duets.
- Selected music must be Class A / Grade 5 or higher with a time limit of 6 minutes.
- The piece you audition on must be the same piece that you play at the recital.
- An accompanist will be provided if needed; please bring the accompanist part or a copy for the accompanist.
- Auditions take place during check-in but are separate from your placement audition.

▶ OPPORTUNITY: Honors Solo Recital with Class Voice Elective
APPLIES TO: Choral Ensemble Camp

A maximum of 16 students will be selected to perform on Thursday evening (June 11) in an Honors Solo Recital. These selected campers will be assigned to Class Voice as one of their electives where they will have time each day to work on their solo. They will also work with the faculty as one of the featured singers during the daily masterclass. Family of the performers are welcome to attend the performance, and performers will receive an audio recording of the recital.

What to prepare if you wish to audition:

Prepare a classical solo of your choice. An accompanist will be provided; please bring original sheet music and the accompanist part or copy if you wish to use the accompanist. The piece that you audition with must be the piece that you want to sing at the Solo Recital and use during masterclass. If you are auditioning for the Chamber Choir as well (see below), you can use the same piece for both auditions.

▶ OPPORTUNITY: Chamber Choir
APPLIES TO: Choral Ensemble Camp

A limited number of students will be selected to rehearse and sing in a Chamber Choir in addition to their TB/SA and Mixed Choir. This will be assigned as one of their daily electives. The Chamber Choir performance will be part of the final choir concert on Saturday morning.

What to prepare if you wish to audition:

Prepare a classical solo of your choice. An accompanist will be provided; please bring original sheet music and the accompanist part or copy if you wish to use the accompanist. If you are auditioning for the Honors Solo Recital as well (see above), you can use the same piece for both auditions.

Check In Day Continued:

Optional Opportunities

These additional opportunities do not require auditions.

For the optional opportunities below, you will use your elective preference form (in your online account) to let us know that you are interested.



OPPORTUNITY: Rehearse & Perform with the Orchestra
APPLIES TO: High School Band Camp (Session 1 & 2)

String Orchestra Camp takes place at the same time as High School Band Camp, and students who are interested in playing with the full orchestra will have the opportunity to be considered for a spot. Interested students should note the following:

- The instrumentation will vary depending on the music being played by the orchestra.
- If you are selected, it will take the place of one of your two daily elective classes and masterclass.
- If you are selected, you will be playing in an additional concert. This concert will take place on Saturday morning at 9:00am.

What to do if you wish to be considered:

On your elective preference form (in your online account) you will be able to answer this question: *"If your placement audition score qualifies you, would you like to participate with the full orchestra?"* Submit that form with the check box for "yes", and your score from your placement audition, along with the instrumentation needs of the orchestra, will be used to determine if you are selected. No separate audition is required.



OPPORTUNITY: Instrument Doubling
APPLIES TO: High School Band Camp (Session 1 & 2)

Do you play piccolo? Eb clarinet? How about English horn or alto clarinet? If you play a doubling instrument and want to bring it to camp, please do so. You will audition on your primary instrument, and play your primary instrument in your ensemble, but you may be considered to play your secondary instrument based on the instrumentation needs of the music.

What to do if you have a doubling instrument:

On your elective preference form (in your online account) you will be able to answer this question: *"Will you be bringing a doubling or second instrument with you to camp?"* and *"If yes, what instrument(s)?"*

Let's Talk Instruments

.....▶ **ALL CAMPERS NEED TO BRING THEIR INSTRUMENT** *(There are a few exceptions and additions listed below.)* ◀.....

FSU does not have any instruments available for camper use. If you do not own your instrument, we suggest contacting your school music director and arrange to use a school instrument during your camp. If you have extenuating circumstances which may prevent you from bringing your instrument to camp, please contact the camp office. Rental instruments are also available locally through Playground Music Center (850-785-1355).

▶ **Percussion at High School Band Camp and Middle School Band Camp**

Bring sticks and mallets in a stick bag, and practice pads (if you have them). Suggested sticks and mallets to bring are snare sticks, and mallets for vibes, glockenspiel, xylophone, marimba, and timpani.

▶ **Drums at Jazz Ensemble Camp**

- ▶ • A 4-5 piece drum kit - snare drum, 1-2 rack toms, floor tom, cymbals (ride, crash, and hi-hat), and hardware (hi-hat stand, cymbal stand(s), drum throne, bass drum pedal)
- ▶ • Drumsticks and brushes.

We will provide a drum set for your audition. Plan to unload your personal drum set AFTER the audition and store it in the Housewright Music Building room 088. On Sunday evening, the drum kits will be moved by the campers and staff to various rehearsal and combo rooms. See the FAQ on page 10 for more information.

▶ **Electric Bass at Jazz Ensemble Camp**

In addition to your instrument, you should bring an amp, cables, and an extension cord.

▶ **Double Bass at Jazz Ensemble Camp & String Orchestra Camp**

In addition to your instrument, you should bring a bar stool labeled with your name.

Jazz Bass: If you plan to play with a pick-up, you should also bring an amp, cables, and an extension cord. Playing with a pick-up is optional.

▶ **Electric Guitar at Jazz Ensemble Camp**

In addition to your instrument, you should bring an amp, cables, and an extension cord.

▶ **Piano at Jazz Ensemble Camp & Piano Institute**

A metronome and a pair of headphones with a 1/4" stereo jack. You can purchase adapters online at amazon and monoprice.com

▶ **Brass Players at All Camps**

If possible, bring a mute or selection of mutes.

▶ **Everyone**

Be sure to bring any applicable accessories such as rosin, rock stops, cleaning cloths, valve oil, reeds, extra strings, etc. Please label your belongings.

Let's Talk Instruments

CONDITION & REPAIRS



Please make sure that your camper's instrument is in good working order prior to coming to camp. If an instrument is not playable, or if an instrument becomes unplayable during camp, parents will be contacted about repairs.

Repairs will not be made to any instrument without the written consent of the parent, and all costs for instrument repair are the parent's responsibility. We utilize Music Masters in Tallahassee for all repairs.

If an instrument is not playable, not repairable, or if the family does not wish to have repairs done in Tallahassee, we will do our best to locate a loaner instrument. In these cases we cannot guarantee that anything will be available, or guarantee what condition the loaner instrument will be in. We may suggest parents rent an instrument for the remainder of camp.

CASES & CARRYING

You will be using your instrument all day in a campus setting, which means that you will be carrying (or rolling) it between classrooms and buildings, up and down hills and stairs, in hallways, on sidewalks, and backstage. Depending on your schedule, some classrooms may require walking to another building that is pretty far away. Elevators are not usually available.

Now is a great time to think about how you can most easily transport your instrument (we're looking at you Tuba and Double Bass!) There may also be times that you have to store your instrument in a public (locked and secure) place. Please consider using a hard sided case whenever possible.

STORAGE

Small Instruments

Night campers who play small instruments will keep their instrument in their dorm room and transport it with them to their classes. Day campers should bring their instrument from home each morning and back home each evening.

Medium Sized Instruments

Night campers who play medium sized instruments will be assigned a locker. The locker number and combination will be printed on your name tag which you will receive at check-in. Due to limited availability, you may be assigned a shared locker with another camper. Please do not throw away items that are in your locker when you arrive - they may belong to your locker mate. If there are items in your locker when you arrive that ultimately do not belong to you or your locker mate, please bring them to the Help Desk so we can find their owner.

Day campers who play medium sized instruments should bring their instrument from home each morning and back home each evening.

Large Instruments

All campers (day and night) who play large or oversized instruments will be provided with a secure room to lock up their instrument. The storage location will be printed on your name tag, and you will be directed to the storage location during check-in.

Singers

Campers at the Choral Ensemble Camp and Treble Choir Camp are required to purchase music for their choirs online before coming to camp. You will be purchasing it from a company called Beethoven & Company. We will know the exact price of the packet by the end of May, and will send out an email with links and instructions on how to purchase it.

Each camper must have their own copy - no sharing. The packets will be handed out at check-in upon your arrival.

Health & Wellness

The health and safety of our music camp community is our top priority. In order to protect all of our campers, counselors, instructors, and staff, the following is our protocol for managing illness that presents at camp:

GENERAL MEDICAL CARE

There may be times that campers have a medical concern which has nothing to do with feeling unwell. In these cases, campers will be brought to a local urgent care facility. First responders, 911, The Tallahassee Memorial Hospital, or Capital Regional Medical Center will be utilized for all emergency situations.

The FSU Summer Music Camps does not have a nurse on staff and employees of the Summer Music Camps are not responsible for making health decisions on behalf of the campers. All medical care will be given by a health professional at one of the facilities listed above.

ILLNESS

If an **overnight camper** is not well enough to be in class or at an activity, they should go to the dorm office for evaluation. Even if they are just tired, they must go to sick bay for rest - they can not stay in their room. In the dorm office, the camper will have their temperature taken.

If the camper is running a fever, arrangements must be made for the camper to go home immediately. The counselor and camper call home to update the parents about their condition and make a pick-up plan. The counselor will collect the campers cell phone and take them to sick bay. Parents will be given the phone number for the camp office; this number will be the only way for parents to reach their camper while the camper is in sick bay.



We can keep the camper in sick bay until the parent/guardian is able to travel to Tallahassee to take the camper home, however, parents must be prepared to collect the camper within 24 hours. If a camper must be sent home due to illness there are no refunds.

If the camper is not running a fever, or if the camper is in sick bay for an injury, the counselor will have the camper call home to update the parents about their condition. Parents can choose to either come and get the camper, or allow the camper to remain in sick bay and be monitored for up to 24 hours.

The counselor will collect the campers cell phone and take them to sick bay to focus on rest (this applies to all campers regardless of the reason they are in sick bay). Parents will be given the phone number for the camp office; this number will be the only way for parents to reach their camper while the camper is in sick bay.



After 24-hours in sick bay: If the camper continues to be fever-free and starts feeling better, they can return to camp activities at any time. Their cell phone will be returned to them when they are signed-out of sick bay. If the camper is still not well enough to return to camp activities, or if the camper has developed a fever, parents must make arrangements to come to Tallahassee to take the camper home. We can continue to keep the camper in sick bay until the parent/guardian is able to travel to Tallahassee, however, parents must be prepared to collect the camper within 24 hours. If a camper must be sent home due to illness there are no refunds.

If a **day camper** is feeling unwell, DO NOT SEND THEM TO CAMP.

If the camper has a fever, please call our office to notify us that they will be absent. They must be fever-free (without the aid of medication) for 24 hours before they can return to camp activities.

If a day camper feels unwell but does not have a fever, do not send them to camp that day. Please call our office to notify us that they will be absent. If they feel better with rest, their symptoms are completely gone, and there is no fever, the camper will be allowed to return to normal camp activities the next day.

Health & Wellness

MEDICAL INFORMATION

There is a required medical form in your online account. Please fill this form out completely and accurately. It is our main source of information in a medical emergency, and we ask that you give us any information that will be important to providing a safe and healthy environment for your child. We do not require vaccination records or a physical.

MEDICATIONS

We do NOT supply or dispense medication of any kind.

You have three choices for how medications can be handled at camp:

1. **SUPERVISED SELF-ADMINISTRATION:** Medications that you pack are turned in at the camp office, and counselors will supervise the camper who will self-administer medications as instructed by you.

OR

2. **UNSUPERVISED SELF-ADMINISTRATION:** Your camper can keep the medication(s) that you pack in their room and self-administer as you instruct. In this case, camp staff will not be involved with your child's medication(s) at all. We ask for you to tell us what medications they will have in their possession in case of emergencies.

OR

3. **NO MEDICATIONS:** If you do not pack any medications for your child, they will not have access to ANY medication while at camp.

You will be asked how you would like medications handled on the **Medication Selection Form** in your online account.

This policy applies to all prescription or over-the-counter medications; taken daily or as-needed. The most common ailments at camp are headaches and stomach aches, so it is suggested that you pack with this in mind.

INSURANCE INFORMATION

Any and all costs which may be incurred for medical care during the course of the camp will be the family's responsibility.

For camper's with insurance, a copy of the camper's medical insurance card is required. If you do not have insurance, if you have TriCare, or if you can not provide a copy of the medical insurance card, there will be a spot on the form for you to indicate that you can not provide a copy of your card.



Get Ready To Walk!

Camper's will do A LOT of walking as this is a college campus. They will walk back and forth on the "trail" several times per day, change classes, go to other buildings that may be far apart, walk to recreation events....SO MUCH WALKING all day, every day. And it's hot.

So please prepare for this by:

- WEARING COMFORTABLE SHOES.
- Bringing an umbrella.
- Dressing in layers!
- Bringing some band-aids or moleskin in case you get blisters.

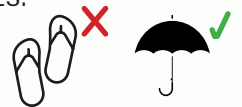

Flip flops may seem like comfortable summer footwear, but they can be dangerous when the sidewalks and stairs are wet (which they will be when it rains every afternoon just as you are trying to walk back to the dorm). We encourage you to bring footwear that won't land you in the hospital.

Keep Our Camp Community Healthy

Illness can spread quickly at camp because we spend a lot of time together in close contact. To keep everyone healthy, camper's should ask themselves daily:

- In the past 24 hours, have I felt sick, feverish, or unwell?
- Have I had any of the following new symptoms? (fever, cough, sore throat, shortness of breath or trouble breathing, sneezing unrelated to allergies headache, body ache, runny nose, stuffy nose, watery eyes, tiny white spots inside mouth, flat red spots on the face or body).
- Do I have any symptoms that are getting worse?

- If the camper answered NO to all of the above, great!
- If the camper answered YES to anything, do NOT go to class. Let a counselor know immediately. If they are a day camper, keep them home.

Day Camper Details

All the fun of camp, and you get to sleep in your own bed!

- Day campers are required to attend all rehearsals, performances, and classes. This includes any evening rehearsals and performances, as well as performances on weekends and holidays (Juneteenth and July 4th).
- Day campers are required to attend Sunday check-in.
- Day campers are welcome, and encouraged, to participate in evening activities.

Drop-off And Pick-Up for Monday - Friday

Drop-off begins at 7:30am at the crosswalk in front of the Housewright Music Building on Copeland Street. Classes will start promptly at 8:00am. On the first day, campers will need to stop at the Help Desk to get their class schedule, so they should plan to arrive no later than 7:45am.

Afternoon pick-up is at the same location at 5:00pm.

Students who have not been picked up by 5:30pm will have to walk over to the Southgate Dorm with our staff, and be picked up from the dorm office on the 2nd Floor.

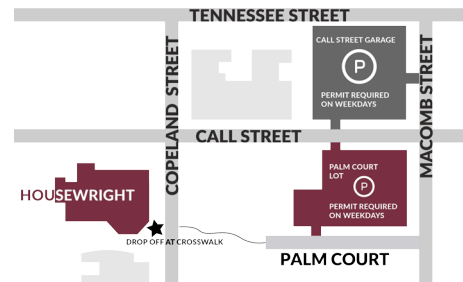

Day Camper Parking

- Day campers who are dropped-off and picked-up each day do not need any kind of parking permit.
- Day-campers who will be driving themselves to camp should purchase an FSU parking permit. These are available to purchase in your online account and cost \$20.00 for a weekly pass. It will allow you to park in any un-gated FSU Parking lot in faculty/staff/student spaces.
The deadline to purchase a parking permit is MAY 26 for camps beginning on June 7 or June 14, and JUNE 8 for camps starting on June 21 or June 28. Parking permits are non-refundable. Parking permit will be available for pick-up at camp check-in with your name tag.

Supplies To Bring Each Day

- Your Instrument (also see pages 18-19)
- Backpack
- Notebook
- Folder
- Pens, Pencils
- Refillable Water Bottle
- Umbrella
- Music Stand

A foldable, compact one is best as you will be carrying this from class to class, and building to building.

(Everyone should bring this except vocalists and pianists).

- Music
- Instrument Accessories: Bring rosin, rock stops, cleaning cloths, valve oil, reeds, extra strings, etc.
- Ear Plugs
(optional, but some campers have found that having a pair of ear plugs available can be very helpful during long rehearsal days)

Day Camper Details



Evening Activities For Day Campers

How To Sign Up

Each evening there will be some type of camp activity. Some evenings this is a concert, and other evenings there are options for various recreation activities. Day campers are welcome to participate in all evening activities, though it is not required.

Once activities are finalized, you will be notified (via email) that a new form has been added to your online account. This form will ask for the camper's preferences for evening activities on the nights when there are multiple choices. Any fees for optional activities will also be listed so that you can plan accordingly.

We will always try to assign campers to the activities that they request, but we cannot always guarantee it. Some activities have participant limits set by the venue, or we are limited by the number of practice rooms, room capacity, etc... Activities will be assigned based availability and the date that the preference form was submitted. After the deadline there will be no changes until after camp starts.

How To Confirm & Pay For Activities At Check-In

At camp check-in on Sunday, Day Campers will be directed to a station where you can review the camper's assigned evening activities. You will need to pay for the activities that have a fee at this time. These activities can only be paid for WITH CASH, so please come prepared. If you are unable to pay for the activities at check-in, the camper will need to go to the Southgate Campus Centre at lunch on the day of the event to pay for the activity.

How To Drop-off and Pick-Up Day Campers For Evening Activities

Campers need to be picked up at 5:00pm and brought back for any evening activity unless you purchased a dinner package.

- If the event is on-campus, the camper can go directly to the event location at the designated start time.
- If the event is off-campus, the camper should arrive at the Southgate Campus Centre at the designated time and travel to the event with the group. For accountability purposes, parents may NOT drive day-campers directly to an off-campus event.

Day campers who purchase a dinner package will walk back over to the dorm with the other campers, and then stay in the cafeteria, in the lobby area of Southgate, or in the 2nd floor dorm office until evening activities begin.

For all events (both on and off-campus) parents will pick-up their camper from the 2nd Floor Camp Office at the Southgate Campus Centre. Campers will not be released from off-campus locations under any circumstance. Day campers who eat at Southgate are NOT able to go up into the dorm rooms to visit with overnight campers.

Day Camper Details



Day Campers Meals

Meals are not included for day campers unless you purchase a dining package.

LUNCH:

Day campers can either bring lunch from home to eat in a designated area at the College of Music, or purchase a lunch package to eat in the cafeteria. Food from home is not permitted to be brought into the cafeteria due to health regulations. The Lunch Package is \$35.00 and includes 5 lunches to be used Monday – Friday.

DINNER:

Day campers who purchase a dinner package will walk back over to the dorm with the other campers, and then stay in the cafeteria, in the lobby area of Southgate, or in the 2nd floor dorm office until evening activities begin. The Dinner Package is \$35.00 and includes 5 dinners to be used Monday – Friday.

HOW TO PURCHASING DINING:

Lunch and dinner packages must be purchased IN ADVANCE. The deadline to purchase meal packages is the Sunday one week before your camp check-in. Lunch and dinner packages are non-refundable once purchased. The dining hall does not accept payment at the entrance to purchase meals.

Your camp name tag will indicate that you have purchased a meal plan and allow you entry to the cafeteria. If your name tag is lost or damaged, please see a counselor right away for a replacement.

If you need assistance with adding a dining package to your registration, please call our office.



Day Camper Performance Information

Performance times are listed on page 25. Drop-off instructions, locations, and times for performance days will be sent out during the camp week.

Day campers should plan to arrive on campus in their performance attire with their instrument when they are dropped-off for performances.

Day campers can leave directly from the performance location at the end of camp.

Performance Attire

FRIDAY CONCERTS:

Choral Ensemble Camp, Treble Choir Camp, String Orchestra Camp, and Jazz Ensemble Camp

Please wear the following for your Friday night concert:

- Jeans
- A Garnet or Maroon t-shirt
(we love the camp t-shirt which you can buy at check-in!)

SATURDAY CONCERTS:

All campers at **Choral Ensemble Camp, Treble Choir Camp, String Orchestra Camp, High School Band Camp, Middle School Band Camp** or **Jazz Ensemble Camp** are required to wear one of the attire options listed below for their final performance on Saturday:

Option #1

- Black dress shirt (long sleeve)
- Black pants (no jeans)
- Black dress shoes
- Black socks

Option #2

- Black dress (below the knees or longer; 3/4 length or longer sleeves)
- Black dress shoes
- Black stockings/tights

Option #3

- Black skirt (below knees or longer)
- Black shirt (3/4 length or longer sleeves)
- Black dress shoes
- Black stockings/tights

OTHER CONCERTS:

Campers at the **Piano Institute**, and campers performing in one of the **Honors Solo Recitals** may wear recital attire of their choice. Selected attire does not have to be black, but should be appropriate for a recital. No jeans.

Night Camper Details

After receiving a room key, campers can only leave the dorm by being signed-out (in the Dorm Office on the 2nd floor or in the Southgate Lobby) by parents or individuals listed under authorized check-out (page 26).

On check-in day, all night campers must be in their rooms by 6:00pm to go to Orientation.

About The Dorm

➤ All campers stay in a privately-owned dorm called the Southgate Campus Centre located at 675 West Jefferson Street, Tallahassee, FL 32304. The building is staffed with a 24-hour security desk in the main lobby.

➤ There is a camp office located on the 2nd floor of the dorm which is staffed by our counselors from 6am-11pm. After 11pm there will be an on-duty counselor available for late night assistance.

➤ A camp store will be set up in the dorm office to sell snacks, beverages, and commonly needed items. The camp store accepts cash only.

➤ Campers will be walked to and from the dorm, and all activities, by the counselors. Campers are not permitted to go anywhere on campus unaccompanied.

The dorm rooms are old-school, plain rectangle rooms. Each room will house three (3) campers; there is no option to request a private room.

Each dorm room is 220 sq. feet with its own bathroom, and will contain three beds, one wardrobe for storage, two sets of drawers for storage, two desks, one overhead ceiling light, a shower curtain, and toilet paper. There is one window and one air conditioning unit in each room.

Beds are raised slightly off the ground for storage:

- Under Bed 1 there are 4 storage drawers
- Under Bed 2 there are 4 storage drawers
- Under Bed 3 is open space.

Even though the diagram shows the beds made, we DO NOT provide pillows, sheets or blankets.

You will NOT be able to adjust the air conditioning temperature - doing so results in too much moisture in the room. Most campers find the rooms to be cold, so bring a warm blanket.

The room will be cleaned prior to your arrival. Campers are responsible for keeping rooms clean on a daily basis including picking up and throwing away trash, and wiping down high touch surfaces. Please be considerate of your roommates and keep your area tidy.

Lost room keys should be reported right away to a counselor or dorm office. All keys must be returned at check-out. There is a \$25.00 fee for lost keys.

Males are housed on the 2nd floor of the dorm. Females are housed on the 3rd floor of the dorm. The 4th and 5th floor may be utilized as well, and may be used as mixed gender floors separated at opposite ends. Rooms are assigned based on the gender that was selected on the camper's registration form, and the camper's age. Unless there is a specific roommate request, we will assign the camper with two other roommates of the same age (+/- 1 year) and gender. (Roommate request info is on next page).

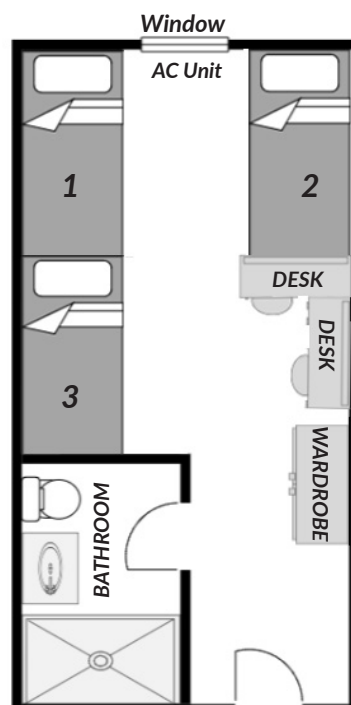
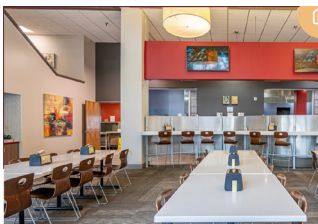

Night Camper Details

Staying For More Than One Session?

If the camper is joining us for two or more consecutive sessions, you have the following options:

1. Check-out from the first camp on Saturday after the performance and spend the night off-campus. The camper returns for check-in on Sunday for the second camp. Campers will work with their counselor at the end of the first camp to find out if they will need to move rooms, or if the camper will be able to leave their belongings in their current dorm room on Saturday night.

OR

2. Book an extra night of housing and stay in the dorm on Saturday night. Extra nights are \$75.00 per night and include the extra night, extra meals, and supervision. Counselors will bring all stay-over campers to check-in for the next camp on Sunday, so parents do not need to be present for check-in at the second camp. Typically students who stay over do not need to move rooms but its not guaranteed. Extra nights can be purchased in your [online camp account](#).

Roommates and Roommate Requests

Campers are able to request a roommate(s) if they wish. To request a roommate, use the Roommate Request Form in your [online account](#).

- You can request to room with campers that are attending a different camp as long as the check-in and check-out dates are the same.
- All campers involved in the request must submit their own request form so that we see that everyone does want to room together. For example, if Sally, Julie, and Mary want to room together, each of them must submit a roommate request form with all three names on it.
- Males and females cannot request each other.
- Roommate assignments are NOT confirmed prior to camp. You will find out your room assignment and roommates at check-in.
- Every effort will be made to honor your request but there are no guarantees. Room configurations are subject to availability.



Meals

- ▶ The dining hall is located on the first floor of the Southgate Campus Centre. Three meals per day are included for overnight campers.
- ▶ The meal plan begins with dinner on Sunday (check-in day).
- ▶ Your name tag is your meal admission, so if it is lost or damaged please see a counselor right away for a replacement.

The dining hall is set up like a food court/buffet. It will always include a hot entree station and beverage station at all meals. During breakfast, cereals, bagels, English muffins are also available; during lunch and dinner a salad bar, and dessert station are added.

DIETARY ACCOMMODATIONS

If you indicate on your Housing & Dining Information Form that your camper has food allergies, religious requirements, or other dietary restrictions, we will provide that information to the dining hall director. The Dining Director is an employee of Sodexo, the company which manages the dining hall at the Southgate Campus Centre. She will be working with her staff and a registered dietitian to create a camp menu that meets your needs. She may reach out to you prior to the start of camp if additional information is needed, but if she has all of the information that she needs from your form, then you may not hear from her directly. If you have specific questions or concerns about your dining arrangements, you may reach out to her at: donna.jones@sodexo.com. Please be sure that any communication with her specifies the FSU Summer Music Camps and includes your child's name and the week they are attending camp.

Food for campers with accommodations will be found in a separate area of the dining hall; it will not be on the main serving line. If campers are unable to locate their allergen free meals, they can ask any dining employee for assistance.

FOOD DELIVERIES

Campers may have food or other items delivered to the dorm if they wish. Counselors will go over all dorm rules at Orientation, and will cover the times that food can be delivered. Campers are NOT permitted to go outside to meet delivery drivers - the driver must come into the dorm lobby to deliver any food to campers.

Night Camper Packing

BEDDING & TOWELS

- Sheets
(extra-long twin)
- Blanket
- Pillow / Pillowcase
- Bath towel
- Hand towel / Washcloth
- Pool Towel
(to use outside; we don't go swimming)

TOILETRIES

- Shampoo / Conditioner
- Body wash / Face wash
- Hand Soap
- Toothbrush / Toothpaste
- Deodorant
- Makeup
- Makeup remover
- Contact Lenses / Lens solution
- Styling products
- Nail clippers / Tweezers
- Shaving supplies
- Hair brush
- Hair dryer / curling iron / flat iron

GENERAL SUPPLIES

- Your Instrument
(see pages 18-19)
- Backpack
- Notebook
- Folder
- Pens, Pencils
- Refillable Water Bottle
- Umbrella
- Music Stand
(Vocalists and pianists do not need one. A foldable, compact one is best. Campers need to carry this between classrooms and buildings).
- Music
(audition music for placement auditions or optional auditions)
- Instrument Accessories
Bring rosin, rock stops, cleaning cloths, valve oil, reeds, extra strings, etc.
- Ear Plugs
(some campers have found that having a pair of ear plugs available can be very helpful during long rehearsal days).

HEALTH CARE ITEMS

- Feminine products
- Hand Sanitizer
- Thermometer
- Band-aids
- Topical cream for bug bites
- Daily Medications
- As-Needed Medications
- Sunscreen

ELECTRONICS & ROOM SUPPLIES

- Cell phone & charger
- Headphones
- Hangers for your clothes
- Alarm Clock
- A lock on your luggage to secure your valuables
- Small lamp or reading light
(there is only one light in the room and it is not bright).
- Laundry detergent / dryer sheets
(if you plan to do laundry)
- Cleaning wipes
- Computer
(Only if you will be doing classwork for a summer course)

CLOTHING FOR EVERYDAY

- T-shirts
- Shorts
- Jeans / Pants
- Sweatshirt / Sweater / Jacket
- Pajamas
- Underwear
- Bras
- Undershirts
- Sunglasses
- Hat / Sun visor
- Belt
- Rain Jacket
- Sneakers / Tennis shoes
- Comfortable, closed-toe shoes
- Theme Day clothing/accessories
(optional; see pages 29-32).

PERFORMANCE CLOTHES: SATURDAY

All campers (except Piano Institute) are required to wear one of the performance attire options listed below for their final concerts on Saturday:

Option #1

- Black dress shirt (long sleeve)
- Black pants (no jeans)
- Black dress shoes
- Black socks

Option #2

- Black dress (below the knees or longer;
3/4 length or longer sleeves)
- Black dress shoes
- Black stockings/tights

Option #3

- Black skirt (below knees or longer)
- Black shirt (3/4 length or longer sleeves)
- Black dress shoes
- Black stockings/tights

Campers at the Piano Institute may wear recital attire of their choice. Selected attire does not have to be black but should be appropriate for a recital. No jeans.

PERFORMANCE CLOTHES: FRIDAY

If you are in Choral Ensemble Camp, Treble Choir Camp, String Orchestra Camp, and Jazz Ensemble Camp, you will need to bring the following for the Friday night concert:

- Jeans
- A Garnet or Maroon t-shirt
(Hint: we love the camp t-shirt which you can buy at check-in!)

PERFORMANCE CLOTHES: OTHER

*If you are auditioning for an Honors Solo Recital, you may wish to bring separate recital clothes (of your choice) for that performance. Selected attire does not have to be black but should be appropriate for a recital. No jeans.

Night Camper Packing F.A.Q.

Can I bring a fridge or microwave?

Yes, you are permitted to bring these items but please keep in mind that the rooms are VERY small. After you put three people with luggage and personal items into the room, there is very little space left for a fridge or microwave.

Can I bring food to have in the room?

Yes, you can bring food/snack items for your rooms. Please bring nut-free items that are individually packaged to avoid allergy problems. Rooms do not have refrigerators or microwaves, so anything you bring will need to be kept and eaten at room temperature. Outside food is not permitted in the dining hall due to health code regulations.

Can I bring a computer, TV, or gaming system?

Yes, but there is no wifi or cable in the room. These items are your responsibility. The camps are not responsible for damage, theft, or loss of any personal item.

What is the item that campers most wish they brought with them?

It's a tie between:

- A mattress pad (the mattresses are not plush)
- A warm blanket (the rooms are very cold)
- A light (the rooms are very dark)

What if I leave something important at home?

Once you are checked-in at the dorm, your parents (or an authorized sign-out person) can sign you out at the camp office and you can go run errands. We have a Target, CVS, Walmart, and other stores close by. You just need to be back by 6:00pm.

If you forgot something and can't leave to get it, we may have it available at the camp store in the dorm office. Ask your counselor.

If you forgot something essential and it can't be replaced in Tallahassee, you can have your family ship it to you via the instructions for MAIL under the Camps A-Z section. Use FedEx or UPS or you will not get it in time.

Can I bring an e-scooter?

No. They are prohibited on FSU's campus. Other prohibited items can be found on the Camper Conduct Agreement.

Check In F. A. Q

How long will check-in last?

It depends on your camp. You should allow at least two hours to check in, complete a placement audition, go to the dorm and get settled. It may take longer depending on how long the line is at your placement audition room.

What do I need to do before check-in?

Before check-in, please make sure you do the following:

- Pay your balance (June 1 deadline)
- Complete your supplemental forms
- Prepare for any placement or optional auditions

Do I have to attend check-in every week if I'm coming to multiple sessions?

Yes. At each check in the camper will receive a new name tag and/or materials that pertain to that camp. If the camp has a placement audition, you will do a new placement audition each week.

Do I need a parent with me at check in?

No. As long as you are paid in full, and have completed all of the required camp forms, you do not need a parent to check you in. If you will not have a parent/guardian with you at check-in, be sure to come prepared with everything you need, such as money to sign up for private lessons, your placement audition music, and everything on the camp packing list! We suggest contacting the camp office two weeks prior to check-in to be sure everything is all set for your arrival without a parent/guardian.

Can I drive myself to camp?

Yes. If you are a night camper you will park your car on the 3rd floor or higher at the Southgate Parking Garage where it will remain for the week. You do not need a parking permit. You can not drive your car once you are checked-in. You will be able to check yourself out and drive yourself home at the end of camp.

If you are a day camper driving yourself, you will need a parking permit. See Day Camper Information on page 16.

What happens if we are accidentally running late to check-in?

If unexpected travel delays cause you to miss your check-in time, here is what to do:

- If check-in is still open, then come to the Housewright Building as soon as you arrive.
- If check-in has ended and you are a night camper, go directly to the Southgate Campus Centre to the 2nd Floor Camp Office.
- If check-in has ended and you are a day camper, you will need to check-in on Monday morning before your first class. Please go to the Help Desk in the lobby of HMU when you arrive on Monday morning

Check-in ends at 3:00pm on June 7

Check in ends at 2:00pm on June 14, June 21, and June 28.

Where can I eat on check-in day?

The first meal available under the dining plan is dinner on Sunday. Please plan out your breakfast and lunch since check-in can be busy, and you want to make sure you eat! Campus dining options on Sunday in the summer are non-existent, so you will need to plan to get food off-campus. There are food options nearby on Tennessee Street, Monroe Street, and Appalachian Parkway.

What if I can't arrive to camp on check-in day?

Check-in is required for all campers - including day campers. If you are unable to attend check-in on Sunday, please call our office to make arrangements for a late arrival. Based on your arrival day and time, we will give you instructions on where to go. Please be aware that arriving late to camp will likely effect your ensemble/chair placement. For High School Band students, missing the placement audition will make you ineligible for placement in the Wind Symphony and Orchestra Winds.

I am a jazz drummer. Where do I bring my drum kit?

After you have completed your audition, you can drive to the Housewright parking lot as shown below. You can unload your kit on this lower level and it will be stored in room 088 until Sunday evening. On Sunday night, after schedules are handed out, students and staff will move the kits to rehearsal and combo rooms.

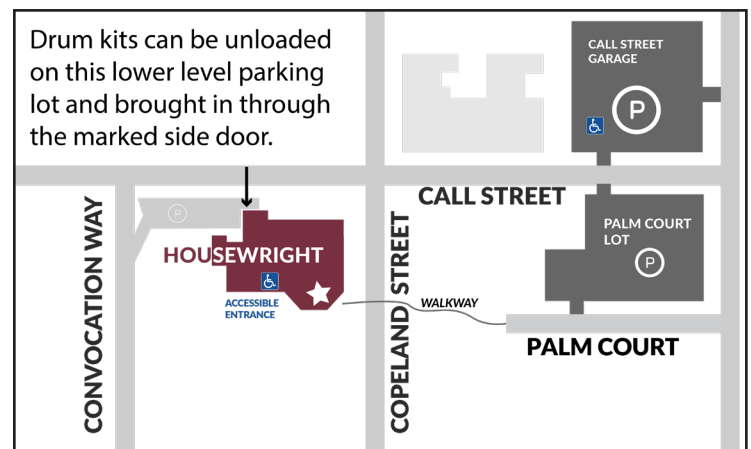

Performances

Time to show off the hard work!

All campers will receive a free digital download AUDIO (NOT VIDEO) recording of their final performance. Information about accessing the recording will be sent to families via email after camp has ended.
Recordings typically become available in September.

- All performances are free. No tickets are needed.
- Seating is general admission. All concert halls open 30 minutes prior to the start of the performance. To arrange reserved seating for guests with accessibility needs and/or limited mobility, please contact our office.
- Personal, non-flash photography/video is allowed but please be respectful of the performers, conductors, and other audience members. Parents may videotape for personal use, but FSU does not approve for these videos to be posted on YouTube or in any other online format due to releases and permission. Commercial recording equipment is not permitted.
- No pets allowed except certified service animals.
- No food or drink allowed.

CONCERT PARKING

No permit is required for Saturday concerts. You can park in any FSU Parking Lot.

Parking for Friday concerts will be in reserved parking lots. The reserved lots are Westcott North, Westcott South and Diffenbaugh (shaded in Garnet on the map). Parking in any other lot requires a permit, and without one you may receive a ticket.

Guests with accessibility needs and/or limited mobility may be dropped off at Ruby Diamond’s Accessible Entrance, which is located at the north entrance of the concert hall. The drop-off roundabout may be accessed via Convocation Way. This is for drop off only - DO NOT PARK IN THE ROUNDABOUT!

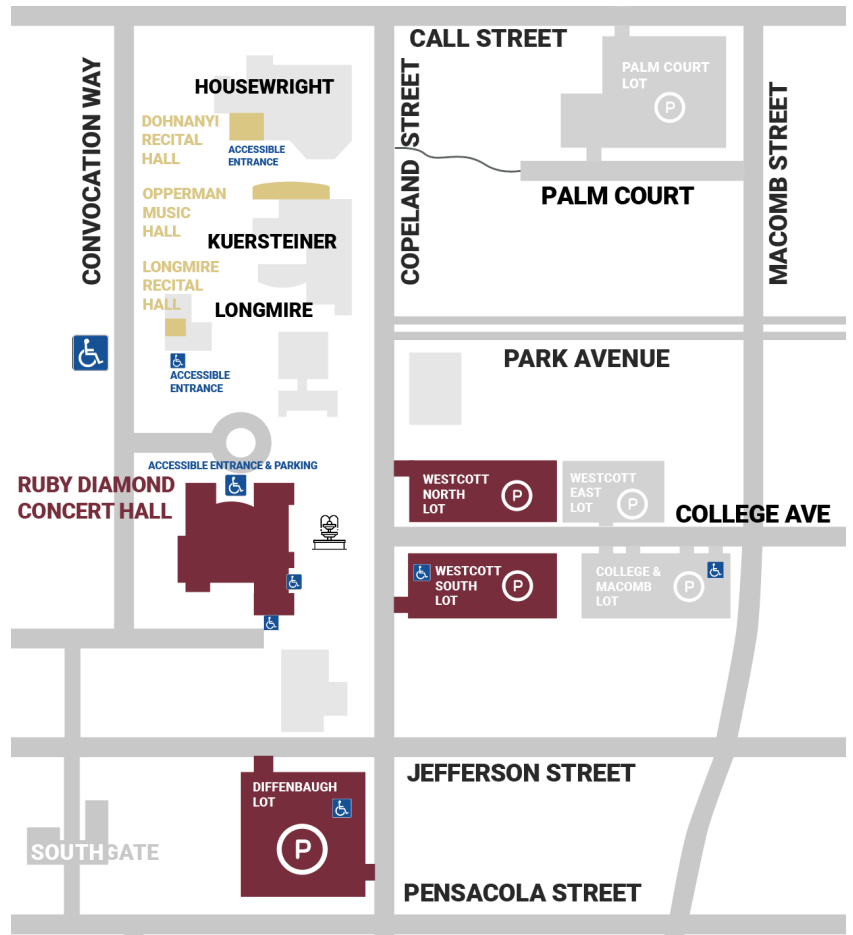

Performances

Choral Ensemble Camp:

Thursday, June 11 at 7:00pm - Honors Solo Recital - Dohnanyi Recital Hall *(selected campers perform)*

Friday, June 12 at 7:00pm - Ensembles Performance - Ruby Diamond Concert Hall

Saturday, June 13 at 10:00am - Choir Performance - Ruby Diamond Concert Hall

Treble Choir Camp

Friday, June 12 at 7:00pm - Ensembles Performance - Ruby Diamond Concert Hall

Saturday, June 13 at 10:00am - Choir Performance - Ruby Diamond Concert Hall

Jazz Ensemble Camp

Friday, June 12 at 7:00pm - Combos Performance - Opperman Music Hall

Saturday, June 13 at 10:30am - Big Band Performance - Opperman Music Hall

Piano Institute

Saturday, June 20 at 10:00am - Final Recital - Longmire Recital Hall

High School Band Camp Session 1

Thursday, June 18 at 7:00pm - Honors Solo Recital - Ruby Diamond Concert Hall *(selected campers perform)*

Saturday, June 20 at 12:00pm - Final Performance - Ruby Diamond Concert Hall

**If your camper is playing with the Orchestra, they will also perform at 9:00am on Saturday, June 20. See page 10 for info.*

String Orchestra Camp Session 1

Thursday, June 18 at 7:00pm - Honors Solo Recital - Ruby Diamond Concert Hall *(selected campers perform)*

Friday, June 19 at 7:00pm - Chamber Ensembles Performance - Ruby Diamond Concert Hall

Saturday, June 20 at 9:00am - Orchestra Performance - Ruby Diamond Concert Hall

High School Band Camp Session 2

Thursday, June 25 at 7:00pm - Honors Solo Recital - Ruby Diamond Concert Hall *(selected campers perform)*

Saturday, June 27 at 12:00pm - Final Performance - Ruby Diamond Concert Hall

**If your camper is playing with the Orchestra, they will also perform at 9:00am on Saturday, June 28. See page 10 for info.*

String Orchestra Camp Session

Thursday, June 25 at 7:00pm - Honors Solo Recital - Ruby Diamond Concert Hall *(selected campers perform)*

Friday, June 26 at 7:00pm - Chamber Ensembles Performance - Ruby Diamond Concert Hall

Saturday, June 27 at 9:00am - Orchestra Performance - Ruby Diamond Concert Hall

Middle School Band Camp

Saturday, July 4 at 10:00am - Final Performance - Ruby Diamond Concert Hall

All times and performance hall locations are subject to change.

Performance Attire is listed on page 13 (day campers) and page 16 (night campers).

Camp A-Z

ATM

There is a SunTrust ATM in the dorm, and a Bank Of America ATM located across from our music buildings.

Attendance

Attendance will be taken at the start of each class, every day. If the camper is not feeling well and cannot attend class, our wellness policy will apply (see pages 14-15).

Attendance at all camp events, rehearsals, and performances is mandatory for all campers. If your child is a day camper and will be absent, please call our office at 850-644-9934 to let us know.

Authorized Check-Out

Campers are only permitted to be signed out by parents, guardians, or approved adults over the age of 18 who are listed in the camper's online account as an authorized person. To check who is listed, or to add individuals, use the "Manage Authorized Pickup" button (circle below) in your online camper account.

The screenshot shows the Active Florida State University Summer Music Camps online account. At the top, it says 'WELCOME, SIGN OUT' and 'English (None)'. Below that, there's an 'ACCOUNT BALANCE' section with 'Credit Balance \$0.00' and 'Balance Due \$195.00'. There are buttons for 'PAY IN FULL', 'Current & Upcoming', and 'Past'. The '2023 MUSIC CAMPS' section shows a 'BALANCE DUE \$195.00' and a 'PAY BILL NOW' button. A 'Pending Waiver' message is visible. The 'REGISTRANTS' section lists 'CAMPER NAME' as 'Elementary Music Day Camp - Head Street (2-3) within 4 years' and '2023 Medical Information Form' and '2023 Insurance Card' with 'FILE OUT' buttons. The 'FAMILY MEMBERS' section lists 'Primary parent' and 'Secondary parent' with 'FILE OUT' buttons. A 'MANAGE AUTHORIZED PICKUP' button is circled in red. There are also 'COMMON QUESTIONS' and 'PARENT/GUARDIAN INFORMATION' sections.

During the class day, campers can check out from the Help Desk in the lobby of HMU. At all other times, campers can be signed-out from the Dorm Office on the second floor of Southgate. All authorized individuals must show ID to sign a camper out.

Day campers who drive themselves to camp can check out to drive home each day. Night campers who drive themselves to camp will be able to check out themselves out to drive home on the last day. If your camper is driving home at the end of camp in another camper's personal vehicle, please include the camper's name as an Authorized Pickup.

Camp Store

A camp store will be set up in the dorm office to sell snacks, beverages, and commonly needed items such as toothpaste and feminine products. These are payable with cash only. There are also vending machines in the music buildings which accept credit and debit cards, or cash, for snacks and beverages.

Check-In Time

You will be assigned a check-in time slot. Time slots help us minimize crowds, and make the process faster for you! This is not your audition time. Just arrival time.

Your time will be sent to you in an email. If you can't find the email, you can call or email us and we can look it up. If you need to change your arrival time, call us or send an email and we will find you a time that works.

Cell Phone Policy

We allow cell phones at camp as long as they are used responsibly. All cell phones and other devices such as smart watches, music players, games, tablets, and other similar devices must be **TURNED OFF COMPLETELY** and **PUT AWAY OUT OF SIGHT** during all classes, rehearsals, and performances.

If a camper is not feeling well and is going to sick bay, their cell phone will be held in the camp office so that they can focus on rest. If a family member needs to reach the camper while they are in sick bay, they can do so by contacting the dorm office.

Campers may not take videos or photos during performances with their phone unless they have received prior approval from the Camp Director, Associate Camp Director, or Dorm Supervisor prior to the event.

If a cell phone is turned on, visible, or being used during class, rehearsals, concerts/performances it may be confiscated according to the following policy by any member of the camp staff:

First Offense: The cell phone will be confiscated for the duration of the event/class/rehearsal/etc but will be returned at the end of the event.

Second Offense: The cell phone will be confiscated for a 24 hours.

Third Offense: The cell phone or device will be confiscated for the duration of camp. The item will be returned at camp check-out. If the cell phone is confiscated, parents will still be able to contact the camper through the Camp Offices.

Camp A-Z

Counselors

Day counselors are with the campers while they attend classes during the day, and also participate in some of the evening recreation activities. Day counselors are primarily undergraduate College of Music students and are a great resource for campers that want to know more about what it's like to be a student at FSU. Day Counselors are available to assist with anything the campers need; from forgotten items and finding classrooms, to pep-talks and snacks. Day Counselors can be found at the Help Desk in the Housewright Music Building and at Satellite Help Desks throughout the other classroom buildings.

All day campers will have a day counselor assigned to them, and they will meet the counselor at check-in. If you are a day camper, please make sure you meet your counselor before you leave on check-in day.

Our night counselors reside in the dorm with the campers. They supervise the campers whenever they are at the dorm, and during all evening activities.

Night counselors are primarily undergraduate and graduate level FSU College of Music students, or FSU Alumni. Each room will be assigned a specific night counselor. If at any time a camper needs assistance and their primary counselor is not available, there are always night counselors in the dorm office from 6am-11pm. After 11pm there is always an on-duty counselor available for late night emergencies.

Deliveries

Campers may have food or other items delivered to the dorm if they wish. Counselors will go over all dorm rules at Orientation, and will cover the times that food can be delivered. Campers are NOT permitted to go outside to meet delivery drivers - the driver must come into the dorm to deliver any food to campers.

Dress Code

The dress code for all camp activities is casual (shorts, t-shirts, jeans, etc) but should be appropriate for classroom instruction and for group recreation activities. Revealing clothing is not permitted, and it is at the discretion of the camp staff to require campers to change or cover-up if an outfit is deemed inappropriate.

Elective Class Preferences

If your camp offers electives, you will find an elective preference form in your [online account](#). Though we will make best efforts to put you in your top choices, classes are

assigned based on availability. Elective forms are typically added into your account in April.

Evening Activity Preferences

When activities have been finalized, you will be notified (via email and on the camp app) that a new form has been added to your [online account](#). This form will ask your [preferences](#) for evening activities on the nights when there are multiple choices. We will always try to assign all campers the activities that they want, but we cannot always guarantee it. Some activities have participant limits set by the venue, or we are limited by the number of practice rooms, room capacity, etc... Activities will be assigned based on the date that your preference form is submitted. After the deadline, changes can only be made after camp starts.

Day Campers will go over their selected evening schedule, and pay for activities at camp check-in.

Night Campers will go over their selected evening schedule with their counselors. Payment for activities that have a fee will be paid **in cash** to the counselors on the day of the event.

Exercise and Sports

We sometimes offer recreation activities that include sports like kickball, volleyball, football, and basketball, but we cannot make accommodations for campers to workout or practice other sports while at camp. There is not enough time in the camper's schedule, and we do not have access to fitness or sports facilities. Campers are not permitted to go running by themselves. Campers may not sure the gym located in the Southgate Campus Centre.

Forms

You can find required and optional camp forms in your [online camp account](#). This will include medical forms, housing request forms, class preference forms, evening activity preference forms and more.

Holidays

Camp continues on a regular scheduled on Juneteenth (June 19), and the Fourth Of July (July 4). Campers will attend classes and have regular camp events on these days.

Homesickness

Most of our campers are so busy that they don't have time to miss home! We get far more calls from parents who are surprised that they haven't heard from their kids all week, than those that have homesick children. But homesickness

Camp A-Z

is common at all summer camps, and it can affect both first-time and seasoned campers. New places and new experiences can make some kids nervous, but our counselors and instructors have lots of ways to help your camper engage, meet new friends, and ease homesickness. Campers are always welcome to call home, and if you believe that your camper is experiencing homesickness you can always let us know so that we can ensure the counselor is aware. If homesickness is something you are concerned about, there is a lot of great information available on the Internet about preparing for camp. Here is one great [link](#).

Internet & Classwork

Students who need to do classwork for virtual school or other academic classes will be able to sign-up for work time as an evening activity on nights when there are not required rehearsals. Students will need to bring their own laptop or personal device, and internet will be available in the camp office.

Laundry

The dorm has laundry facilities. The machines use a laundry card which can be purchased with a debit card or you can use quarters. At the time of publishing this handbook, the average cost of a load of laundry (washing & drying) is \$4.00. The camp store in the dorm office will sell laundry detergent and dryer sheets for \$2.00.

Local Information

Information about Tallahassee can be found at visittallahassee.com. There is a great digital guide with a hotel and restaurant directory, as well as business listings and local area maps.

Lost & Found

We maintain a lost and found at the Help Desk and at the Dorm Office. Any items left or lost can be returned [at the family's expense](#) via the UPS store on campus. Items not claimed by July 10 will be donated or discarded. Call 850-644-9934 or email musiccamps@fsu.edu for help with Lost and Found.

Mail

If you are planning to send mail to a camper while they are at camp, we suggest you do the following:

- Send it before they leave.

Our campus mail system slows the process down by as much as four days! We often receive cards and letters for campers long after their camp has ended. By sending mail the week before your camper leaves, we will be able to give

it to them during the camp week. Any packages which need to be forwarded after camp has ended will be at the family's expense.

- Send it to this address:
FSU Summer Music Camps
Attn: Campers Name
122 N. Copeland Street, HMU 204,
Tallahassee, FL 32306-1180
- Send it via FedEx or UPS: DON'T SHIP VIA US MAIL. If you are sending campers anything of value, we HIGHLY suggest sending it via FedEx or UPS. If you use the US Postal Service - even with a tracking number - you will find that once the package leaves the Tallahassee Post Office and enters the campus mail system, the tracking number will no longer work; it will seem like the package has been lost and even the Post Office will not be able to help you track it down. Only FedEx and UPS will enable you to track your package all the way through delivery.
- "Next Day Service" doesn't really mean next DAY on the FSU Campus. Mail and packages are only delivered to the College of Music once per day - usually at about 3:00pm. Even if you pay for AM delivery, expedited overnight service or priority delivery, it won't be delivered to our office until the late afternoon. It will then be given to the counselors who will get it to the camper at dinner time. Bottom line - if you send something on a Tuesday via overnight service, don't expect the camper to get it until Wednesday evening at the earliest.
- Be mindful of holidays such as Juneteenth and July 4th. The FSU campus is closed on those days so we will not receive mail or packages (but we do have camp!)

Medication

We do not supply or dispense any medication. You have three options for how medication can be handled at camp. Please read the Health and Wellness Section, as well as the information on the Medication Selection Form to be sure that you understand the options.

Money

Most of the items that campers spend money on are snacks, drinks, pizza delivery, and recreation activities. There will always be a free activity offered each evening. On some evenings, there will be optional recreation activities offered that have an additional fee, approximately \$15.00-\$25.00. These activities are payable in cash only, and will be paid on the day of the event.

Camp A-Z

We encourage parents to make sure that campers have enough money before they leave. We typically recommend \$50.00 per week as a general rule. It is difficult for parents to get money to campers once they have left campus.

If you are concerned about your child carrying cash (there are no safes in the rooms) you might consider a pre-paid ATM card or a debit card that you can control from home. Pre-paid cards are available at Walmart and most convenience stores or grocery stores. Make sure that the card you select can be used as a debit and ATM card. There is a SunTrust ATM machine in the dorm and a Bank Of America ATM located across from our music buildings.

In the event that you need to send money to a camper after they are here, you will need to utilize the Western Union at the Publix on Ocala Road: PUBLIX #0782, 800 Ocala Rd, Ocala Corner Shopping Center, 850-575-3929. Whoever is receiving the transfer must be able to show ID - so if your child does not have ID they can not pick up a money transfer. You will need to work with your camper and their counselor to determine a time that they can go to receive the transfer.

Policies

All of our camp policies can be found on our website at <https://music.fsu.edu/events/camps-festivals/summer-music-camps/policies/>

Private Lessons

Private lessons are offered at Jazz Ensemble Camp, Senior High Band Camp, Middle School Band Camp, and String Orchestra Camp. (Lessons for Piano Institute are included and scheduled prior to check-in).

Sign-up takes place at camp check-in. Lessons cost \$50 per 45-minute lesson. Lessons payments are made to the TEACHER, not to the camp, and are payable with cash or check only.

The lesson(s) will take place during lunch or during a rehearsal; no lessons are scheduled outside of the 8am-5pm class day. Teachers are assigned based on availability when you sign-up at check-in. Campers may sign up for a maximum of 2 lessons per week.

On the day of your lesson(s) you will meet your instructor at the Help Desk in HMU and sign-in on the sheet at the desk.

Absence policy: If you are absent to a scheduled lesson, we

will give you one opportunity to reschedule, if your instructor has times available for make-ups. If the instructor does not have an available make-up time, the instructor must still be paid for the missed lesson. If your instructor is able to reschedule, and if you are absent again, the instructor will still be paid for the missed lesson. Signing up for lessons implies understanding of the absence policy.

T-Shirts

Camp t-shirts will be on sale at check-in and at most concerts. The t-shirts are \$20.00 and can be purchased using cash, check or credit card. Proceeds from these t-shirts go to the FSU collegiate chapter of the National Association for Music Education (CNAfME).

Sickbay

If an overnight camper is not well enough to be in class or at an activity, they should go to the dorm office for evaluation and to sick bay for rest. No cell phones are allowed in sick bay. Please read the Health & Wellness section for more information.

Visitors

Campers may visit with friends, day-campers, and relatives who are not music campers in the lobby and dorm office at Southgate during the evening hours before curfew. Guests must register at the camp office and are subject to the Rules of Camp. For the safety of all campers, the camp staff reserves the right to deny visitation between campers and non-camp guests.

Visiting FSU

If you are interested in an official tour of the FSU Campus, or meeting with FSU Admissions officer, please visit <https://visit.fsu.edu>. Most campers will have an opportunity to take an "unofficial" campus tour with our counselors if they choose. Our College of Music Admissions Director will visit a camp class to answer any questions.

Camp Schedules

➤ Daily Class Schedule

Campers will follow a personalized class schedule from 8am-5pm each day.

- Night campers are given their individual class schedule by their counselor on Sunday evening.
- Day campers pick up their individual schedule from the Help Desk on Monday morning. Day campers should plan to arrive between 7:30-7:45 on Monday morning to pick up their schedule and find their first classroom.

➤ Evening Activity Schedule

Activities will be planned for each evening. Tentative evening schedules can be found on the next four pages. ALL ACTIVITIES LISTED ARE SUBJECT TO CHANGE.

When specific activities have been finalized, you will be notified (via email) that a new form has been added to your online account. This form will ask your preferences for evening activities on the nights when there are multiple choices. It will also include prices for all paid activities. We will always try to assign all campers the activities that they want, but we cannot always guarantee it. Some activities have participant limits set by the venue, or we are limited by the number of practice rooms, room capacity, etc... You will be notified by email when the preference form is available.

➤ Performance Schedule

All performance times are listed on page 25. Information about attending performances is on page 24.

➤ Camp Check-Out

All camps end with a performance. After the final performance, campers can meet up with their families and return to the dorm where they will collect their belongings and check-out. Day campers may leave from the performance hall with their families.

If someone other than the parent/guardian(s) on the camp registration will be taking the camper home from camp, please make sure that the person taking the camper home is included in your online camp account as an Authorized Pick-Up (see page 26 for more information). If the camper drove to camp on their own, they will be able to leave on their own when camp ends.

Campers should make sure that their room is left clean, check to make sure they have all items before leaving, and return their room key.

➤ After Camp Is Over

The camp office will be open until July 17 from 9am-4pm. The office will be closed from July 20-August 14; during this time there will be no staff in the office, but email and voicemail will be checked on a limited basis. The office will return to a regular schedule on August 17st at 9:00am.

Information about Summer 2027, including the anticipated registration opening date, will be sent out in the fall.

Overview Schedule

WEEK 1: 6/7-6/13

DATE	CAMP	ACTIVITIES & PERFORMANCES
Sunday, June 07	Jazz Ensemble Camp	Check in 1:00-3:00pm (check your email for your arrival time slot) Camper Orientation 7:00pm
	Choral Ensemble Camp	
	Treble Choir Camp	
Monday, June 08	Classes begin at 8:00am. Night Campers receive their individual class schedules on Sunday evening. Day campers will pick up their class schedule at the help desk on Monday morning.	
Monday, June 08 7:00-9:00pm	Jazz Ensemble Camp	Faculty/Staff Performance
	Choral Ensemble & Treble Choir Camps	Sectional Rehearsal
	Treble Choir Camp	Recreation (options TBA), on-campus movie, or virtual school work time
Tuesday, June 09 7:00-9:00pm	Jazz Ensemble Camp	Recreation (options TBA), jam sessions, practice time, on-campus movie, or virtual school work time
	Choral Ensemble Camp	Recreation (options TBA), un-official campus tour, on-campus movie, or virtual school work time
	Treble Choir Camp	
Wednesday, June 10 7:00-9:00pm	Jazz Ensemble Camp	Faculty/Staff Concert, virtual school work time
	Choral Ensemble Camp	Finale rehearsal
	Treble Choir Camp	
Thursday, June 11 7:00-9:00pm	Jazz Ensemble Camp	Recreation (options TBA), jam sessions, un-official campus tour, on-campus movie, or virtual school work time
	Choral Ensemble Camp	Honors Solo Recital (7:00pm, Dohnanyi Recital Hall) (<i>selected campers perform, all others attend</i>), or virtual school work time
	Treble Choir Camps	
Friday, June 12 7:00-9:00pm	Jazz Ensemble Camp	Combos Concert (7:00pm, Opperman Music Hall)
	Choral Ensemble Camp	Ensembles Concert (7:00pm, Ruby Diamond Concert Hall)
	Treble Choir Camp	
Saturday, June 13	Jazz Ensemble Camp	Big Bands Concert (10:30am, Opperman Music Hall) Check-out following concert
	Choral Ensemble Camp	Choir Concert (10:00am, Ruby Diamond Concert Hall)
	Treble Choir Camp	Check-out following concert



Theme Days

Catch the spirit! We hope you will participate in our theme days, and dress to impress!

- Monday - no theme
- Tuesday - Tie-Dye Tuesday
- Wednesday - Wacky Sock Wednesday
- Thursday - School Pride Day
- Friday - FSU Friday

Overview Schedule

WEEK 2: 6/14-6/20

DATE	CAMP	ACTIVITIES & PERFORMANCES
Sunday, June 14	Piano Institute Senior High Band Camp S1 String Orchestra Camp S1	Check-In 10:00am-2:00pm (check your email for your arrival time slot) Camper Orientation 7:00pm
Monday, June 15	Classes begin at 8:00am. Night Campers receive their individual class schedules on Sunday evening. Day campers will pick up their class schedule at the help desk on Monday morning.	
Monday, June 15 7:00-9:00pm	Piano Institute Senior High Band Camp S1 and String Orchestra Camp S1	Faculty/Staff Performance & College of Music Admissions Q&A Session.
Tuesday, June 16 7:00-9:00pm	Piano Institute	Piano Faculty Recital
	Senior High Band Camp S1 and String Orchestra Camp S1	Recreation (options TBA), un-official campus tour, on-campus movie, practice time, virtual school work time.
Wednesday, June 17 7:00-9:00pm	Piano Institute Senior High Band Camp S1 String Orchestra Camp S1	"Thursday Night Music Club" performance with Dr. Dunningan, recreation TBA, un-official campus tour, on-campus movies, practice time, virtual school work time,
Thursday, June 18 7:00-9:00pm	Piano Institute	Attend Honors Solo Recital, practice time, virtual school work time
	Senior High Band Camp S1 and String Orchestra Camp S1	Honors Solo Recital (7:00pm, Ruby Diamond Concert Hall) (<i>selected campers perform, all others attend</i>), practice time, virtual school work time
Friday, June 19 7:00-9:00pm	JUNETEENTH - YES! THERE IS CAMP TODAY!	
	Piano Institute Senior High Band Camp S1	Attend Orchestra performance, practice time, virtual school work time
	String Orchestra Camp S1	Ensembles Performance (7:00pm, Ruby Diamond Concert Hall)
Saturday, June 20	Piano Institute	Recital (10:00am, Longmire Recital Hall)
	Senior High Band Camp S1	Performance (12:00pm, Ruby Diamond Concert Hall)
	String Orchestra Camp S1	Performance (9:00am, Ruby Diamond Concert Hall)
	All Camps	Check-out following their performances



Theme Days

Catch the spirit! We hope you will participate in our theme days, and dress to impress!

- Monday - no theme
- Tuesday - Tie-Dye Tuesday
- Wednesday - Wacky Sock Wednesday
- Thursday - School Pride Day
- Friday - FSU Friday

Overview Schedule

WEEK 3: 6/21-6/27

DATE	CAMP	ACTIVITIES & PERFORMANCES
Sunday, June 21	Senior High Band Camp S2 String Orchestra Camp S2	Check in 10:00am-2:00pm (check your email for your arrival time slot) Camper Orientation 7:00pm
Monday, June 22	Classes begin at 8:00am. Night Campers receive their individual class schedules on Sunday evening. Day campers will pick up their class schedule at the help desk on Monday morning.	
Monday, June 22 7:00-9:00pm	Senior High Band Camp S2 and String Orchestra Camp S2	Faculty/Staff Performance & College of Music Admissions Q&A Session.
Tuesday, June 23 7:00-9:00pm	Senior High Band Camp S2 and String Orchestra Camp S2	Recreation (options TBA), un-official campus tour, on-campus movie, practice time, virtual school work time.
Wednesday, June 24 7:00-9:00pm	Senior High Band Camp S2 String Orchestra Camp S2	Recreation (options TBA), "Thursday Night Music Club" performance with Dr. Dunningan, unofficial campus tour, on-campus movies, practice time, virtual school work time,
Thursday, June 25 7:00-9:00pm	Senior High Band Camp S2 and String Orchestra Camp S2	Honors Solo Recital (7:00pm, Ruby Diamond Concert Hall) (<i>selected campers perform, all others attend</i>) practice time, virtual school work time
Friday, June 26 7:00-9:00pm	Senior High Band Camp S2	Attend Orchestra performance, practice time, virtual school work time
	String Orchestra Camp S2	Ensembles Performance (7:00pm, Ruby Diamond Concert Hall)
Saturday, June 27	Senior High Band Camp S2	Performance (12:00pm, Ruby Diamond Concert Hall) Check-out following the performance
	String Orchestra Camp S2	Performance (9:00am, Ruby Diamond Concert Hall) Check-out following the performance



Theme Days

Catch the spirit! We hope you will participate in our theme days, and dress to impress!

- Monday - no theme
- Tuesday - Tie-Dye Tuesday
- Wednesday - Wacky Sock Wednesday
- Thursday - School Pride Day
- Friday - FSU Friday

Overview Schedule

WEEK 4: 6/28-7/04

DATE	CAMP	ACTIVITIES & PERFORMANCES
Sunday, June 28	Middle School Band Camp	Check-in 12:00-2:00pm (check your email for your arrival time slot) Camper Orientation 7:00pm
Monday, June 29	Classes begin at 8:00am. Night Campers receive their individual class schedules on Sunday evening. Day campers will pick up their class schedule at the help desk on Monday morning.	
Monday, June 29 7:00-9:00pm	Middle School Band Camp	Faculty/Staff Concert
Tuesday, June 30 7:00-9:00pm	Middle School Band Camp	Recreation (options TBA), practice time, on-campus movie, virtual school work time
Wednesday, July 01 7:00-9:00pm	Middle School Band Camp	Recreation (options TBA), practice time, on-campus movie, virtual school work time
Thursday, July 02 7:00-9:00pm	Middle School Band Camp	Recreation (options TBA), practice time, on-campus movie, virtual school work time
Friday, July 03 7:00pm-9:00pm	Middle School Band Camp	Camper & Staff Talent Show
Saturday, July 04	JULY 4th - YES! THERE IS A CAMP CONCERT TODAY!	
	Middle School Band Camp	Performance (10:00am, Ruby Diamond Concert Hall) Check out after the performance.



Theme Days

Catch the spirit! We hope you will participate in our theme days, and dress to impress!

- Monday - no theme
- Tuesday - Tie-Dye Tuesday
- Wednesday - Wacky Sock Wednesday
- Thursday - School Pride Day
- Friday - FSU Friday



SUMMER MUSIC CAMPS

COLLEGE OF MUSIC

Are You Ready?

- I read the camp handbook.
- I filled out all of my required camp forms in my online account.
- I have paid in full.
- I have prepared for my placement audition (if applicable).
- I know what to pack.
- My instrument is in good condition and ready to go.
- I know when my check-in time slot is.
- I put the camp app on my phone so I can get notifications and see pictures from camp.
- I'm ready to have a fantastic time at camp!

